



Fitting guide

Small shaped pads

MoliCare® Pad

MoliCare® Premium Lady Pad

MoliCare® Premium MEN Pad

MoliCare® Pad (unisex) & MoliCare® Premium Lady Pad

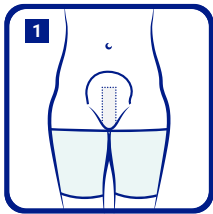

Use pad in conjunction with close fitting underwear.



Remove the paper from the back of the product to reveal the adhesive slip.

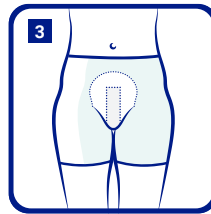

Stick the adhesive strip into the underwear to secure in place.

MoliCare® Premium MEN Pad



Remove the paper from the back of the product to reveal the adhesive slip.

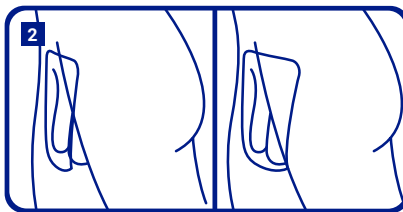

Designed to be worn within own underwear – the adhesive strip keeps the product securely in place.

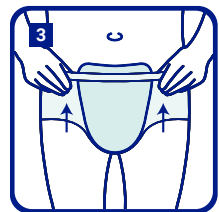

The soft, breathable backsheet ensures maximum comfort.

MoliCare® MEN Pouch 2 Drop:
Male genitalia fits inside the product

MoliCare® Premium Lady Pad For very light to moderate bladder weakness

Absorbency	Code	Working Capacity (ml)	Pack Size	Case Quantity
1	168 132	100	14	12
2	168 636	150	14	18
3	168 646	250	14	12
4	168 684	350	14	12
5	168 670	450	14	12



MoliCare® Premium MEN Pad For very light to moderate bladder weakness

Absorbency	Code	Working Capacity (ml)	Pack Size	Case Quantity
2	168 600	150	14	12
3	168 603	200	14	8
4	168 707	250	14	12
5	168 801	400	14	12



MoliCare® Pad For light to moderate bladder weakness

Absorbency	Code	Working Capacity (ml)	Pack Size	Case Quantity
2	168 100	150	28	12
3	168 101	200	28	6
4	168 102	400	28	6



To order additional products, go to www.hartmanndirect.co.uk or call **0800 028 9490**