

Fitting guide

Rectangular pads

HARTMANN

MoliCare® Rectangular

MoliCare® Rectangular 3,4,5 drop
(standing position)



Choose close-fitting MoliCare® Premium Fixpants.
Remove pads from packaging at least 1/2 hour before usage to allow product to breath and fluff-up for comfort and optimum absorption.

Hold the pad at each end and gently fold it length-ways along the wetness indicator ensuring the cuffs are angled upwards. This activates the inner cuffs and creates an anatomical 'cupped' shape for fitting.

MoliCare® Rectangular 3,4,5 drop
(lying position)



Pull MoliCare® Premium Fixpants as high up between the legs as possible, rolling the waist-band downwards at the same time to form a platform.

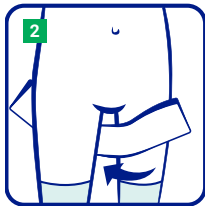

Keep MoliCare® Rectangular cupped and insert between the thighs from the front, with the absorbent and completely white surface next to the skin.

It is important to unfold the MoliCare® Rectangular completely at the rear.

The wetness indicator should be in line with the spine.

Turn patient on their side if they are in a lying position and pull down one side of the MoliCare® Premium Fixpants as much as possible.

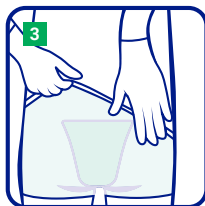

Pull MoliCare® Premium Fixpants right up at the back, then carefully unfold the front area and pull up the Fixpants at the front.

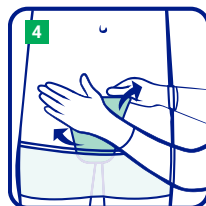

Pull MoliCare® Premium Fixpants up as much as possible, turn patient onto their back and pull the Fixpants over the patient's hips after unfolding the front area.



Ensure that the product fits without folds and with the back of the pad is covering the buttocks.
MoliCare® Premium Fixpants and MoliCare Rectangular should both fit snugly.

MoliCare® Rectangular 3.5 drop

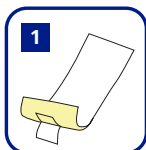

Unfold the MoliCare® Rectangular and remove silicone paper from the back side.

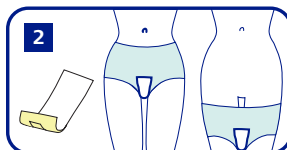

Attach the product with the adhesive strip to your regular underwear.



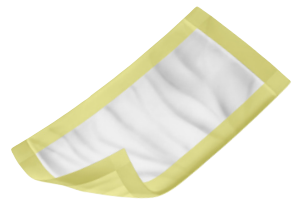

After changing, dispose of the soiled pad in a suitable rubbish bin.



MoliCare® Rectangular For bladder and faecal incontinence



Absorbency	Code	Dimensions	Working Capacity (ml)	Pack Size	Case Quantity
3	160 890	20 x 40cm	150	50	6
3 ^S	148 530	11 x 35cm	250	56	4
4	160 892	20 x 60cm	250	50	4
5	160 860	15 x 60cm	350	28	4

MoliCare® Premium Fixpants For secure fixation of continence pads.

	Colour	Code	Size	Waist/Hip Measurement		Dress Size	Pack Size	Case Quantity
				(inches)	(cm)			
Long leg 	Yellow	947 795	Small	16-32	45-80	8	5	60
	Blue	947 796	Medium	24-40	60-100	10-12	5	40
	Brown	947 797	Large	32-48	80-120	14-16	5	40
	Green	947 798	X Large	40-64	100-160	18-20	5	40
	Grey	947 799	XX Large	56-72	140-180	20-24	5	40
	Orange	947 815	XXX Large	63-79	160-200	26-28	5	40
	Purple	947 830	5X Large	79-94	200-240	28+	5	25
Short leg 	Yellow	947 759	Small	16-32	45-80	8	5	60
	Blue	947 760	Medium	24-40	60-100	10-12	5	60
	Brown	947 761	Large	32-48	80-120	14-16	5	60
	Green	947 762	X Large	40-64	100-160	18-20	5	60

MoliCare® Fixpants

Unisex fixation of continence pads.

	Colour	Code	Size	Waist/Hip Measurement		Dress Size	Pack Size	Case Quantity
				(inches)	(cm)			
Long leg 	Blue	947 763	Medium	24-40	60-100	10-12	5	60
	Brown	947 764	Large	32-48	80-120	14-16	5	60
	Green	947 765	X Large	40-64	100-160	18-20	5	60
	Grey	947 766	XX Large	56-72	140-180	20-24	5	60
Short leg 	Blue	947 745	Medium	24-40	60-100	10-12	4	100
	Brown	947 746	Large	32-48	80-120	14-16	4	100
	Green	947 747	X Large	40-64	100-160	18-20	4	100

To order additional products, go to www.hartmanndirect.co.uk or call **0800 028 9490**