

Getting the best from MoliCare®



Going further
for health



Skin friendly pH of 5.5 which preserves the skin's natural acid mantle. Three-layer absorbent core absorbs the liquid quickly and directs it safely inward leaving the skin feeling dry.



Special superabsorber reliably neutralises unpleasant odours



Fluid repellent inner cuffs ensure optimal leakage protection for added security



Approximately 20% faster application as well as easier and more ergonomic handling for caregivers**



Anatomically shaped products for optimum wearing comfort*



Soft textile-like back sheet provides comfortable feeling and reduces rustling*



The materials used have extremely low potential to trigger allergic reactions

Best use of products:



Store open and unopened packets at room temperature and away from humidity, as moisture will be attracted to the super-absorbent core in the pad.



Remove pads from packaging at least half an hour before use, to allow the cellulose fibres in your product to 'breathe' and 'fluff up' after storage. This will ensure the product will be at its best before use.



Talcum powders and oil based creams can clog the pad. If required use the MoliCare® Skin Barrier cream which is water based and compatible with the MoliCare pads.



The correct fitting of products is very important to allow them to work correctly. Please see the relevant fitting guides for details on this or contact us for more information.



Use a non-rinse cleaner in between pad changes to reduce the risk of Incontinence Associated Dermatitis. MoliCare® Skin cleansers are pH 5.5 skin neutral in order to respect the natural protective barrier of the skin.



Many of the MoliCare® pads include a wetness indicator which is integrated into the backsheet of the products. The wetness indicator will blur or disappear as the product is used and is a guide to when the product needs to be changed.

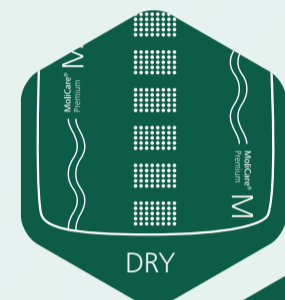

DRY

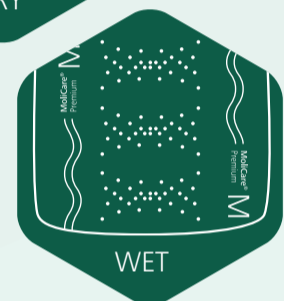

WET

MoliCare® Premium Form Fitting Guide



- Choose close-fitting **MoliCare® Premium Fixpants**.
- Remove pads from packaging at least 1/2 hour before usage.
- Fold the pad lengthways.

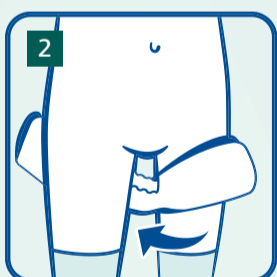

- Pull **MoliCare® Premium Fixpants** as high up between the legs as possible, rolling the waist-band downwards at the same time to form a platform.
- Insert between the thighs from the front, with the absorbent and completely white surface next to the skin.



- Unfold the **MoliCare® Premium Form** completely at the rear and ensure that the wetness indicator is in line with the spine.



- Pull **MoliCare® Premium Fixpants** right up and ensure that the pad is completely unfolded at the front.
- Check there are no folds in the pad and ensure that the **MoliCare® Premium Fixpants** and the pad fit snugly.
- Ensure the leg openings are comfortably positioned and are not pinching the skin.

MoliCare® Premium Elastic Fitting Guide



- Measure both hips and waist and use the larger of the two.
- Remove pads from packaging at least 1/2 hour before usage.
- Fold the pad lengthways.



- Slide the product between the legs from the front to the back.
- Ensure that the product is centred in the correct position by aligning the wetness indicator with the spine.

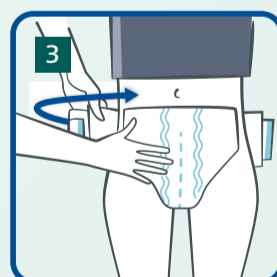

- Fold out the 1st side panel and wrap around the patient's hip.
- Secure the adhesive tape into position.

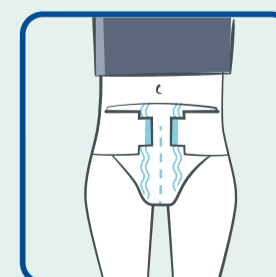

- Repeat on other side by folding out the 2nd side panel and wrap around the patient's hip.
- Secure the adhesive tape into position.